



# Gel Test

Feline Direct Anti-Globulin Test

PROCEDURE



## PROCEDURE FOR FELINE DIRECT ANTI-GLOBULIN TEST (COOMBS TEST)

Material provided :

10 Gel Tests



1 buffer solution



1 box of Gel Tests

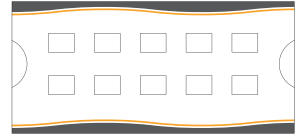

Sample material : Patient's packed red blood cells (pRBCs).  
Preferably drawn into EDTA, CPD or ACD. **Do not use Heparin.**  
For reliable results, use of freshly collected blood is indicated (<3 days at 2 - 8 °C).

Further material required : Centrifuge Hettich EBA270 ; micropipette ; test tubes ; tips.

**WARNING : Use only the swinging bucket centrifuge Hettich EBA270.**

### N°1 : Preparation of material provided before use

Gel Test = Gel tube + Gel support

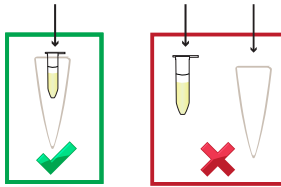

DO NOT  
DISSOCIATE



Allow the buffer solution and Gel Test to reach room temperature before use.

### N°2 : Centrifugation of the Gel Test before use

Centrifuge the Gel Test for 2 minutes at 3000 RPM with Hettich EBA270, in order to remove air bubbles or gel drops in the upper part of the Gel Test.



### N°3 : Preparation of blood sample for DAT

#### Patient :

Centrifuge blood tube for 5 minutes at 3000 RPM, with Hettich EBA270.  
Discard the plasma to collect pRBCs.

**Warning :** If the blood tube is hemolyzed, wash 3 times PBS or NaCl 0,9% to obtain washed pRBCs. **Washing RBCs movie procedure :** [www.alvedia.com](http://www.alvedia.com)

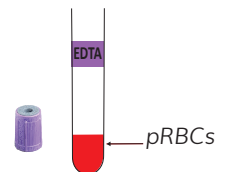

# N°4 : DAT Gel Test procedure

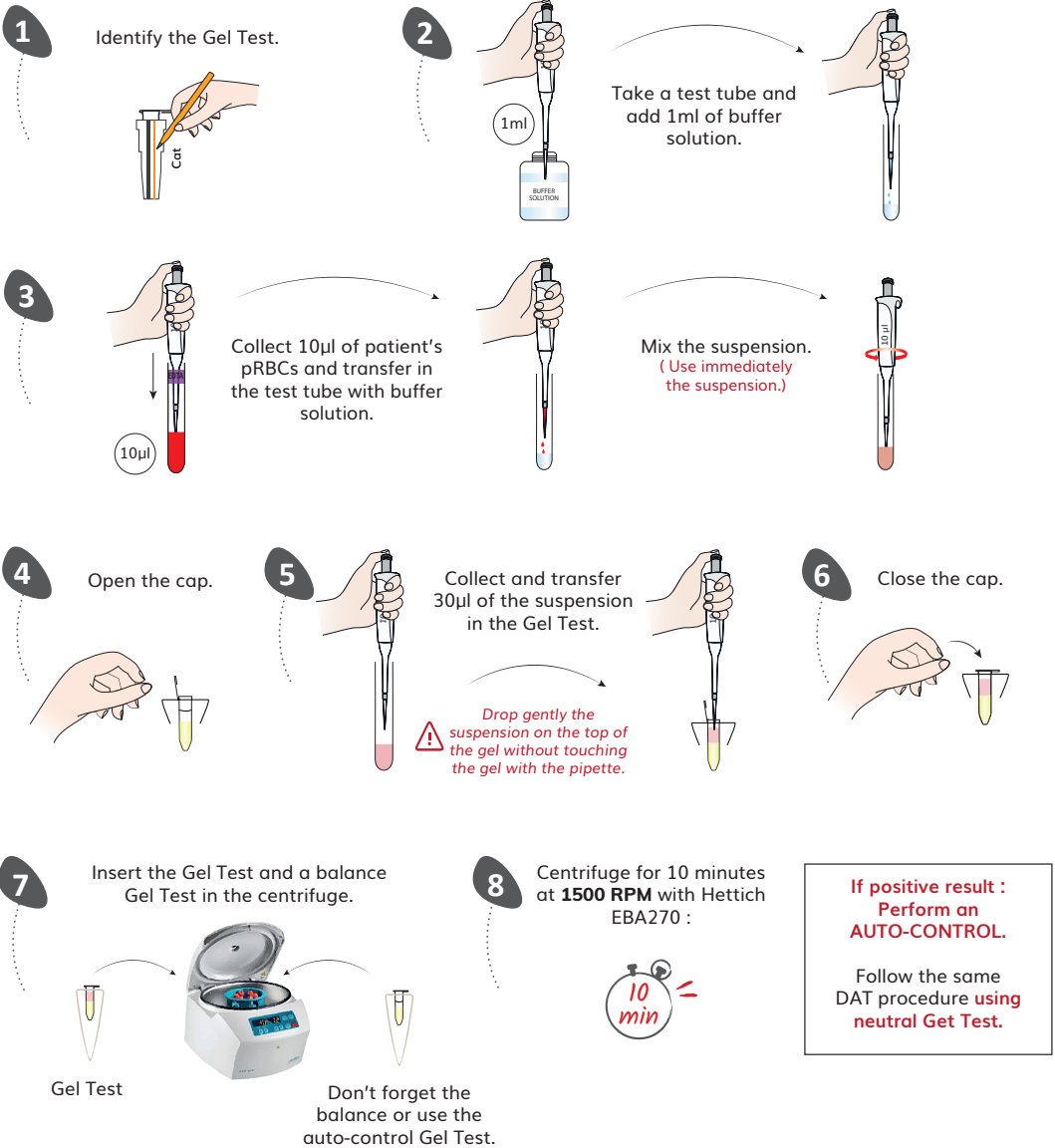

## RESULT INTERPRETATION

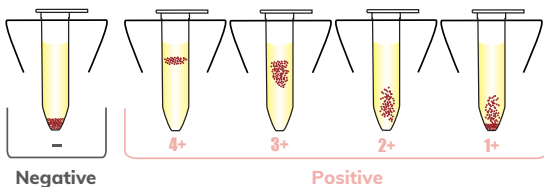

Troubleshooting  
Please contact the  
Scientific Service Laboratory  
contact@alvedia.com  
+33(0)478 380 239

**Alvedia**  
Alice Veterinary Diagnostic

## LIMITATIONS

- Do not use Gel Test tubes which show signs of drying.
- Gel Test tubes which show air bubbles or gel drops in the upper part of the tubes must be centrifuged before use.
- Strict adherence to the procedures and recommended equipment, especially the Hettich EBA270, is essential for a reliable and validated result.
- A non-specific centrifuge (fixed angle centrifuge) will give you false positive results.
- Fibrin residues in the red blood cell suspension may trap non-agglutinated cells presenting a fine pink line on top of the gel while most of the cells are on the bottom of the microtube after centrifugation.
- Use of suspension solutions other than the provided one may modify the reactions.
- Too diluted or concentrated red blood cell suspensions can cause aberrant results.

# VALID GEL TEST



# DAMAGED GEL TESTS

Please contact us for scientific support.

