



Lab. Test BT_{A+B}

Feline result form for blood typing test

FIRST-TIME DONOR : Following human good practice, we recommend to perform blood typing twice using 2 kits / 2 blood samples / 2 operators.

Date :

Patient name :

Identification code :

Typing performed by :

Lab Test lot number :

Blood type : **A** **B** **AB**

To interpret your result, stick the membrane below, respecting the orientation of the membrane :



READ IMMEDIATELY AFTER TESTING

C = CONTROL LINE

INTERPRETATION OF RESULTS

A

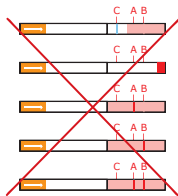

Contact us for the «Troubleshooting procedure»

B

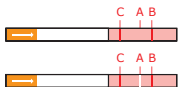

AB



Alvedia
Alice Veterinary Diagnostic

Lab.Test BT_{A+B}

5 min

Feline procedure for blood typing test

Provided by Alvedia :

Additional material needed :



1 buffer



1 membrane



1 result form



1 clean test tube

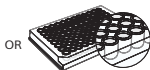

1 microplate



1 pipette

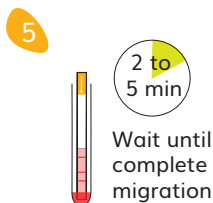
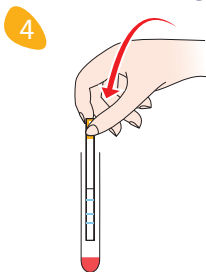
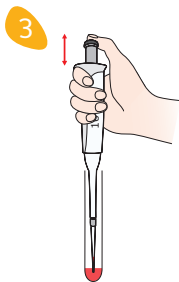
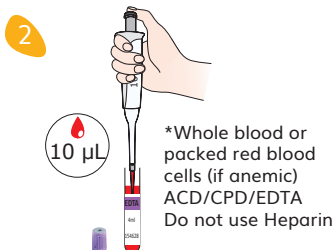
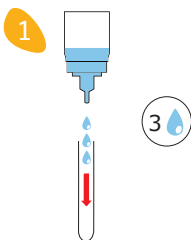

To interpret the result, stick the membrane.

FIRST-TIME DONOR :

Following human good practice, we recommend to perform blood typing twice using 2 kits / 2 blood samples / 2 operators.

Scientific Service Laboratory

www.alvedia.com
contact@alvedia.com